

516 Series

A01 - Floor to Floor

A02 - Floor to Wall

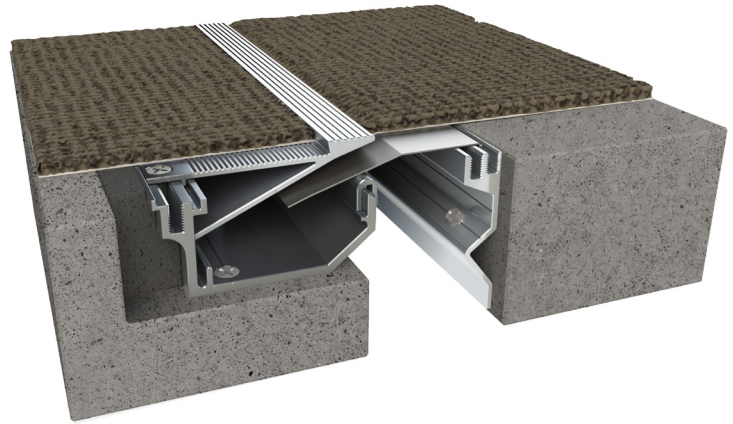

Movement Rating ± 25/50%

Product Guide



Interior



Seismic



Fire Rated Option



Vapor Barrier Option

- ▶ System reduces joint widths of up to 4" (100 mm) down to a narrow sightline of only 1" (25 mm).
- ▶ Specially designed for continuous flooring types such as carpet and vinyl sheet.
- ▶ Stainless steel leaf spring supports heavy pedestrian loads and secures flooring in place during movement.
- ▶ Single, narrow sightline preferred by interior designers
- ▶ ADA compliant
- ▶ Adjustable frame height allows for various carpet pile heights.
- ▶ Perfect for both renovation & new construction projects.
- ▶ System requires blockout only on one side, simplifying construction coordination between trades.

Application	System	W		H1		S		B		Movement +/-			
		Joint Width		Frame Height 1		Sightline		Blockout		Horizontal		Vertical	
		US	mm	US	mm	US	mm	US	mm	US	mm	US	mm
Floor to Floor	516-A01-050	2"	51	2"	51	1"	25	4 1/2"	114	1"	25	1"	25
	516-A01-075	3"	76	2"	51	1"	25	4 1/2"	114	1 1/2"	38	1 1/2"	38
	516-A01-100	4"	102	2"	51	1"	25	4 1/2"	114	1 1/2"	38	1 1/2"	38
Floor to Wall	516-A02-050	2"	51	2"	51	1"	25	4 1/2"	114	1"	25	1/2"	13
	516-A02-075	3"	76	2"	51	1"	25	4 1/2"	114	1 1/2"	38	3/4"	19
	516-A02-100	4"	102	2"	51	1"	25	4 1/2"	114	1 1/2"	38	1 1/2"	38

IPC.837/REV.11

Inprocorp.com • 800.222.5556 • 262.679.9010
 World Headquarters S80 W18766 Apollo Drive, Muskego, WI 53150 USA

JOINTMASTER®
 EXPANSION JOINT SYSTEMS
 A DIVISION OF INPRO®

516 Series

Single Sightline Seismic Floor Systems

516-A01 Floor/Floor
(4" (150mm) system shown)

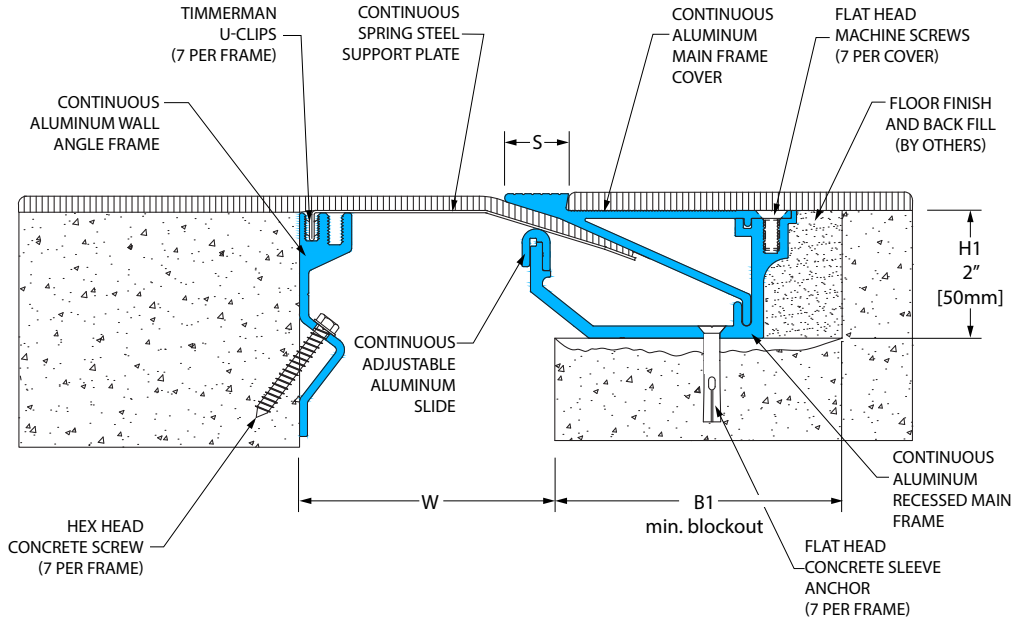

516-A02 Floor/Wall
(3" (75mm) system shown)

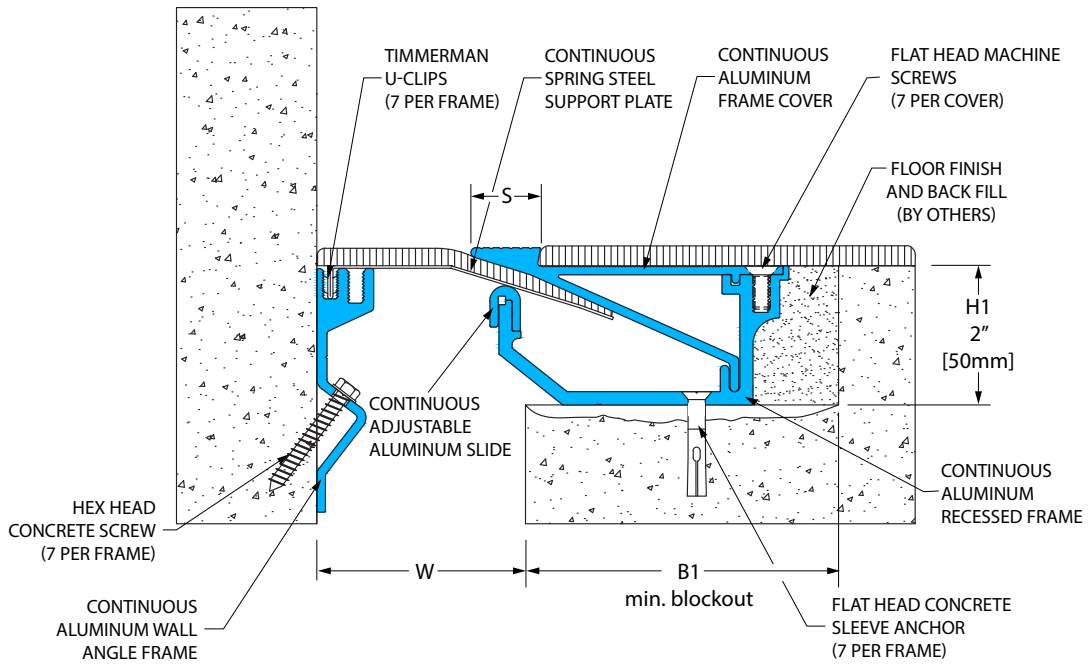

516 Series

Options

Vapor Barrier System
(516-A01-050 system shown)

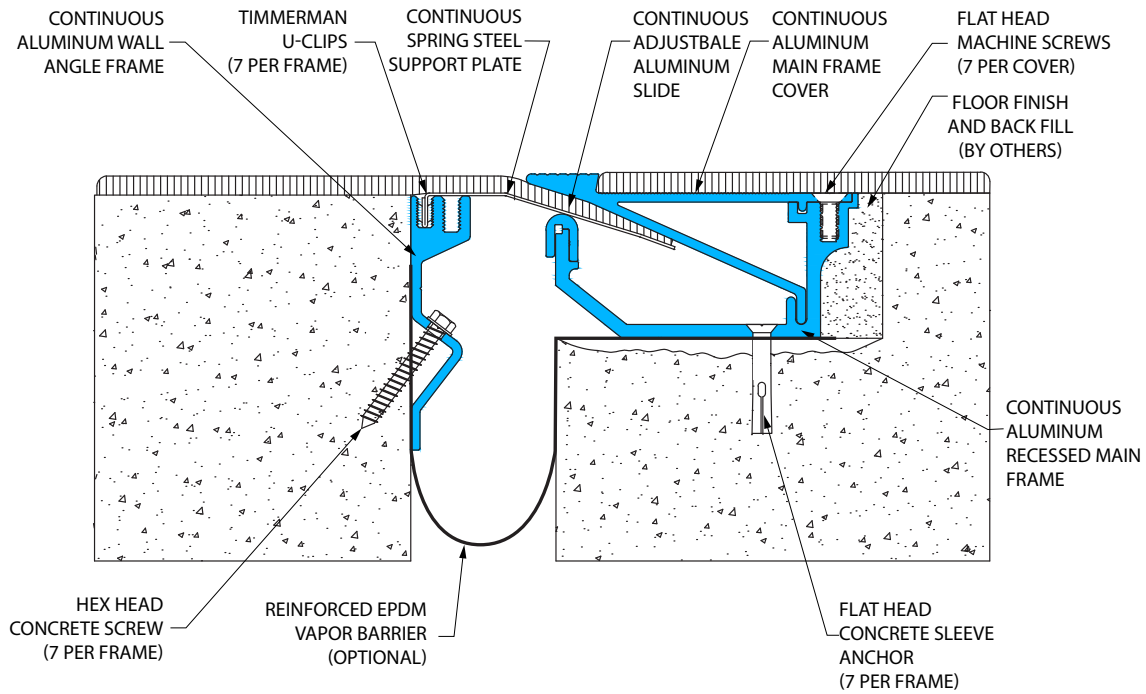

Fire Blanket System
(516-A01-050 system shown)

